

BID 14

Tax lot 22478

Map ID No.4N4W03-BC-09100

Situs Address: 724 Spencer Ave, Vernonia

2021 Assessment RMV \$62,040.00

IMP \$95,220.00

Zoned Residential site

Deeded to County in 2021 by Deed No. 2021-011875 (list No.19-021)

Minimum Bid price \$157,260.00 (15% 23,598.00)

OFFICIAL RECORD

OF DESCRIPTIONS

TAX ACCOUNT NO: 22478

ACCOUNT: 4N4W-03-BC-09100

REAL PROPERTIES

19-021

A tract of land in the Northwest quarter of Section 03, Township 4 North, Range 4 West, Willamette Meridian, Columbia County, Oregon, being more particularly described as follows:

Lot 9, Block 3, Malmsten's Riverside View, in the City of Vernonia, County of Columbia and State of Oregon;

EXCEPTING THEREFROM a tract of land described as follows:

Beginning at the Southeast corner of Lot 9, Block 3, Malmsten's Riverside View, in Section 3, Township 4 North, Range 4 West of the Willamette Meridian, in the County of Columbia and State of Oregon;

thence from said point of beginning North on the East line of Said Lot 9, 10 feet;

thence West and parallel with the South line of said Lot, 20 feet;

thence South and parallel with the East line of said Lot, 40 feet;

thence to the South line of said Lot;

thence East on the South line of said Lot to the point of beginning.

COLUMBIA County Assessor's Summary Report

Real Property Assessment Report

FOR ASSESSMENT YEAR 2021

February 14, 2022 1:38:02 pm

Account # 22478
Map # 4N4W03-BC-09100
Code - Tax # 0401-22478
Legal Descr MALMSTEN'S RIVERSIDE VIEW
 Block - 3 Lot - 9

Tax Status ASSESSABLE
Acct Status ACTIVE
Subtype NORMAL

Mailing Name COLUMBIA COUNTY
Agent
In Care Of TAX COLLECTOR
Mailing Address 230 STRAND
 ST HELENS, OR 97051

Deed Reference # 2021-11875
Sales Date/Price 10-05-2021 / \$0.00
Appraiser MARIE LAGER

Prop Class 101 **MA** **SA** **NH** **Unit**
RMV Class 101 03 00 000 25232-1

Situs Address(s)	Situs City
ID# 1 724 SPENCER AVE	VERNONIA

Code Area	RMV	MAV	Value Summary AV	RMV Exception	CPR %
0401 Land	62,040			Land	0
Impr.	95,220			Impr.	0
Code Area Total	157,260	68,530	68,530		0
Grand Total	157,260	68,530	68,530		0

Code Area	ID#	RFPD	Ex	Plan Zone	Value Source	Land Breakdown			LUC	Trended RMV
						TD%	LS	Size		
0401					OSD - SINGLE FAMILY	100				27,000
0401	1	<input checked="" type="checkbox"/>		VR:R	Residential Site	99	S	5,050.00	001	35,040
Grand Total								5,050.00		62,040

Code Area	ID#	Yr Built	Stat Class	Description	Improvement Breakdown			Total Sq. Ft.	Ex% MS Acct #	Trended RMV
					TD%					
0401	1	1927	131	One story			132	692		95,220
Grand Total								692		95,220

Appr Maint: 2022 - TAX STATUS CHANGE TO NON-ASSESSABLE

Comments: 2018-RA: Home is showing deferred maint i.e. roof is failing, some of the siding is coming off. The garage is really starting to show wear and tear. ML

Columbia County Web Map

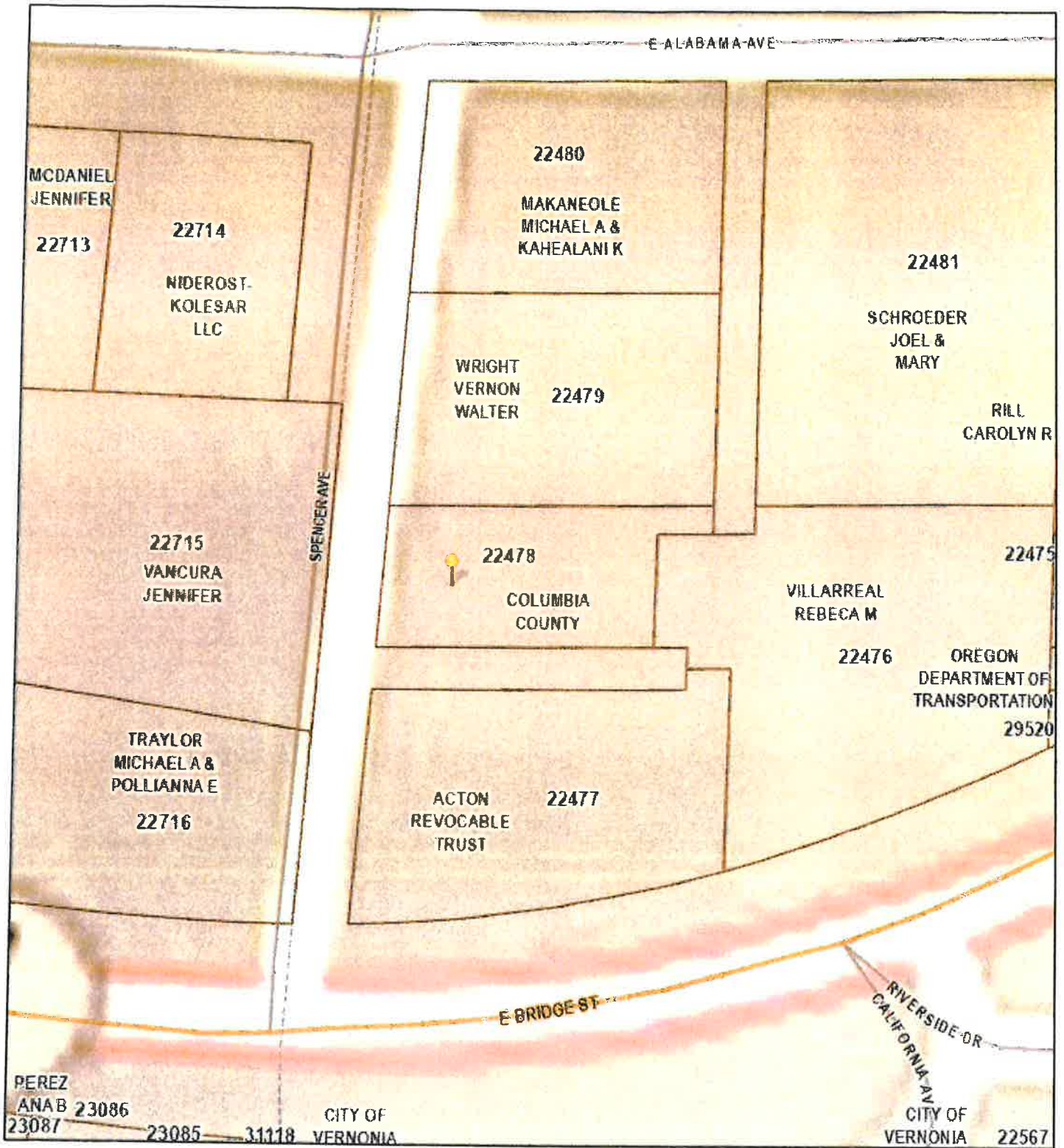

February 14, 2022

